

# Supertree Observatory



Located 50 metres above ground at the canopy of the tallest Supertree, Supertree Observatory is the highest point in Gardens by the Bay. Your guests can soak in 360 degree panoramic views of the Marina Bay area and the lush surroundings of Gardens by the Bay from our open-air rooftop deck.

## Suitable for

- Cocktail Receptions
- Wedding Solemnisations

## Transport / Access

- Nearest carpark is Main Entrance Basement Carpark with 420 carpark lots
- About a 5-minute walk from the Visitor Centre, Coach Bay, Main Entrance Basement Car Park and Bayfront MRT Station

# Supertree Observatory

LEVEL 4 PLAN (ROOF TOP)



LEVEL 3 PLAN (CAFE)

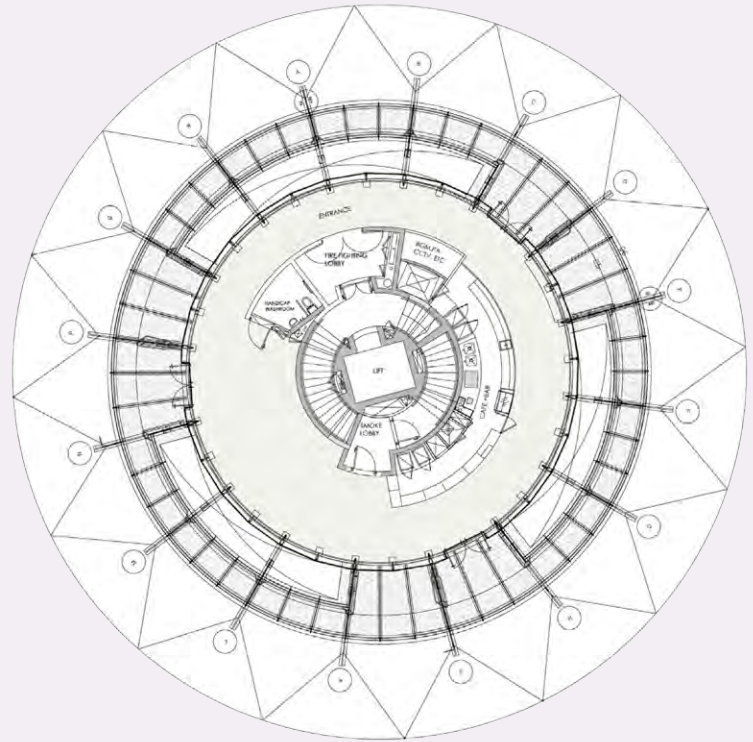

## LOCATION



## Size

- Area for Indoor: 120 square metres
- Area for Roof Top: 140 square metres